

REVISION

REV	DATE	DESCRIPTION
△	4/19/20	INITIAL

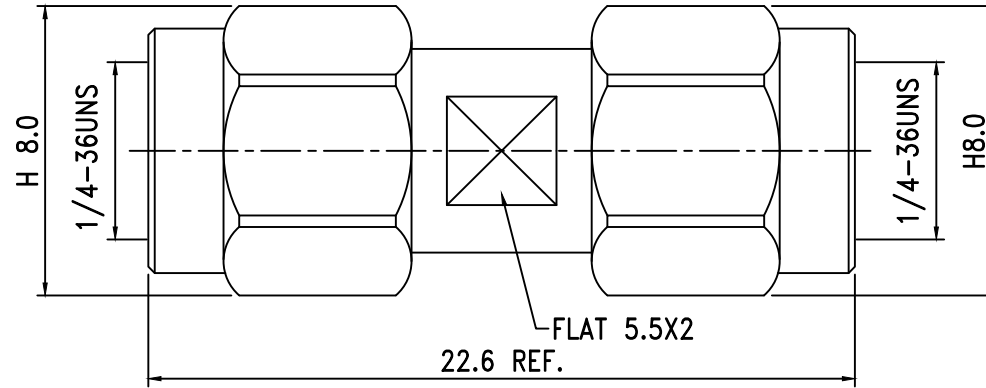

6.	Shell	Brass	2	Nickel
5.	Gasket	Si-Rubber	2	Red
4.	Retaining Ring	SUS304	2	None
3.	Insulation	PTFE	2	White
2.	Pin	Brass	1	Gold
1.	Body	Brass	1	Nickel
NO.	DESCRIPTION	MATERIAL	Q' TY	FINISH

UNITS	SCALE	SIZE	TOLERANCE	DRAWN BY:	CHECKED BY:	CAD FILE
[in] mm	NTS	A	.X +/- 0.2 .XX +/- 0.1 .XXX +/- 0.05 ANGLE +/- 0.5			19-22-1-TGN
SHEET 1 OF 1				PROPRIETARY AND CONFIDENTIAL THE INFORMATION IN THIS DRAWING IS THE SOLE PROPERTY OF TCC INDUSTRIES INC. ANY REPRODUCTION IN PART OR AS A WHOLE WITHOUT THE WRITTEN PERMISSION OF TCC INDUSTRIES INC IS PROHIBITED.		DESCRIPTION Adapter, SMA Female to SMA Female Straight



TCC INDUSTRIES INC.

7050 Village Drive unit E, Buena Park, CA 90621-2282
 Tel. 714.523.8885 - FAX. 714.562.0888
 E-Mail: info@tccinc.com Website: www.tccinc.com